

STAMP OF APPROVAL HERE

मालिक सभा दि. २०/०५/२०१८ रोजी  
 ठरवण २० - वायू कॅम्पेग वॉन मॅमूर



A.S. II  
 ग्राम विकास अधिकारी  
 ग्रामपंचायत कारवाय  
 ता. अंबरनाथ जि. ठाणे

**BUILDING WISE AREA STATEMENT**

NO.	BUILDING NAME	EXISTING AREA	PROPOSED AREA	TOTAL AREA IN SQ.M.
A)	EDUCATIONAL BUILDING (G+2)	5118.09 SQ.M.	03862.76 SQ.M.	7700.75 SQ.M.
B)	EXISTING EDUCATIONAL BUILDING (SH-1)	4410.11 SQ.M.	---	04410.11 SQ.M.
C)	WORK SHOP BUILDING	---	01063.95 SQ.M.	01063.95 SQ.M.
D)	EDUCATIONAL BUILDING (TYPE - A / TYPE - B) (G+5)	549.27 SQ.M.	07040.03 SQ.M.	07609.30 SQ.M.
E)	HOSTEL BUILDING (G+4)	---	01418.94 SQ.M.	01418.94 SQ.M.
F)	HOSTEL BUILDING (G+4)	---	01418.94 SQ.M.	01418.94 SQ.M.
TOTAL c		10077.47 SQ.M.	13537.92 SQ.M.	23615.39 SQ.M.

**TABLE NO. - 1**

**PILOT AREA CALCULATIONS**

QUITE NO.	AREA IN QUITE	AREA IN SQ.M.
110 / 1	248.10	24810.00 SQ.M.
111 / 1	064.30	06430.00 SQ.M.
111 / 2	290.00	29000.00 SQ.M.
111 / 4	080.00	08000.00 SQ.M.
126 / 1	050.00	05000.00 SQ.M.
126 / 2	099.00	09900.00 SQ.M.
141 PT	068.00	06800.00 SQ.M.
114 / 2	080.00	08000.00 SQ.M.
TOTAL c	1007.7	10077.00 SQ.M.

IN ACRES = 27 ACRES 39 QUITE

**AREA STATEMENT**

SR. NO.	ITEM	TOTAL
1	TOTAL LAND UNDER LAYOUT AS PER TABLE NO. 1	10077.00 SQ.M.
2	SET BACK AREA	0447.73 SQ.M.
3	NET PLOT AREA (1+2)	10524.73 SQ.M.
4	PROPOSED OPEN SPACE AS PER RULES ON NET PLOT AREA	4094.00 SQ.M.
5	AMENITY SPACE (1/5 OF NET PLOT AREA)	515.40 SQ.M.
6	PERMISSIBLE (1/3 TO 1/4 OF NET PLOT AREA) (29.04M <sup>2</sup> )	7161.00 SQ.M.
7	EXISTING BUILT-UP AREA	10077.47 SQ.M.
8	PROPOSED BUILT-UP AREA	13537.92 SQ.M.
9	TOTAL BUILT-UP AREA	23615.39 SQ.M.



**SITE PLAN ZONING**  
SCALE - N.T.S.

**LEGEND:**  
 1) ATULVAIDIC COLLEGE AND HOSPITAL CAMPUS  
 2) BHAMBURDA & ARCHITECTURE COLLEGE CAMPUS  
 3) OPEN SPACE  
 4) FUTURE EXPANSION

**SITE PLAN**  
SCALE - 1:1000

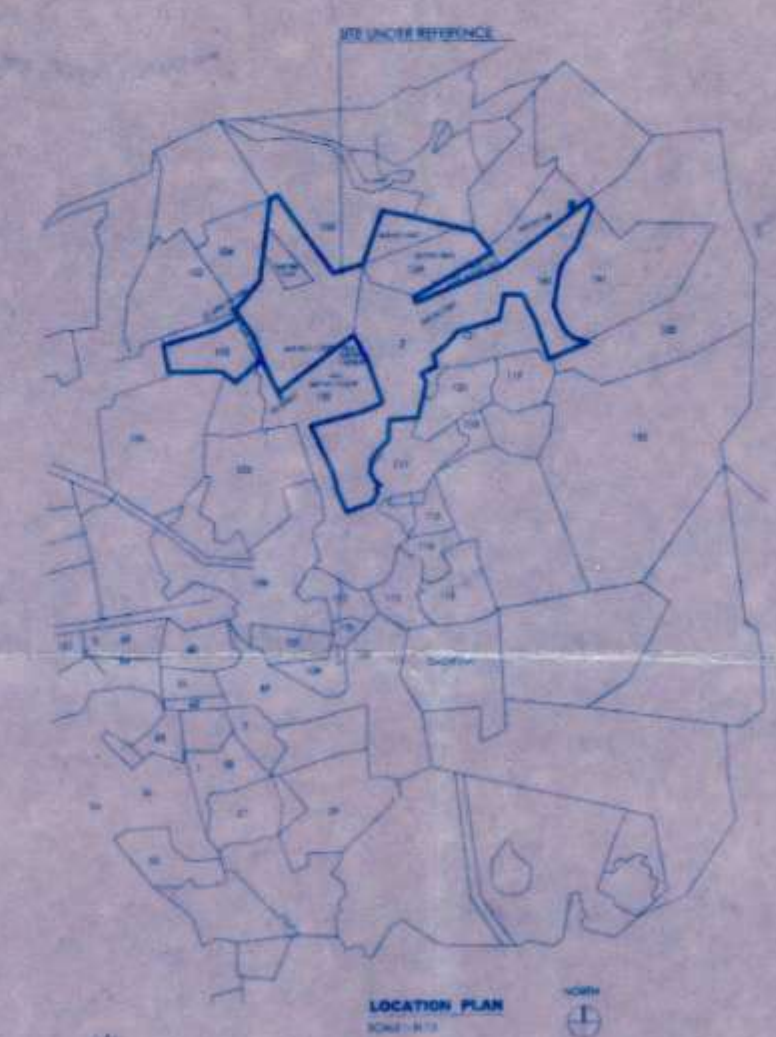

**LOCATION PLAN**  
SCALE - N.T.S.

**LEGEND:**

- 1) EXISTING BUILDING SHOWN IN
- 2) PROPOSED BUILDING SHOWN IN
- 3) DRAINAGE LINE SHOWN IN
- 4) PLOT BOUNDARY SHOWN IN

**PROFORMA - I**

NO.	AREA STATEMENT	AREA SQ.M.
1	AREA OF THE PLOT (10' ZONE)	10077.00
2	DEDUCTION FOR SET BACK AREA	447.73
3	PROPOSED ROADS	---
4	ANY RESERVATION	---
5	TOTAL (1+2+3+4)	447.73
6	NET AREA OF THE PLOT (1+5)	10524.27
7	DEDUCTION FOR RECREATION GROUND (1/5 OF NET PLOT AREA)	4094.00
8	AMENITY SPACE (1/5 OF NET PLOT AREA)	515.40
9	FULL PERMISSIBLE AREA (1/3 OF NET PLOT)	7161.00
10	ADDITION FOR F.S.L. PURPOSE	447.73
11	SET BACK AREA	7161.00
12	TOTAL AREA (9+10+11)	7161.00
13	PERMISSIBLE TOTAL FLOOR AREA	14322.00
14	EXISTING FLOOR AREA	10077.47
15	PROPOSED AREA	13537.92
16	EXCESS BALCONY AREA (TAKEN 24% F.S.L. AS PER B.C.)	447.73
17	TOTAL BUILT UP AREA (14+15+16)	23615.39
18	F.S.L. CONSUMED (13%)	0.33
19	BALANCE OF F.S.L.	---
<b>BALCONY AREA STATEMENT</b>		
A	PERMISSIBLE BALCONY AREA PER FLOOR	---
B	PROPOSED BALCONY AREA PER FLOOR	AS SHOWN IN DRAWING
C	EXCESS BALCONY AREA (TOTAL)	---
<b>TENEMENT STATEMENT</b>		
1	NET AREA OF THE PLOT ABOVE	10524.27
2	DEDUCTION FOR EDUCATIONAL AREA	447.73
3	AREA OF THE TENEMENTS (1+2)	10076.54
4	TENEMENTS PERMISSIBLE (AS PER B.C. 10% F.S.L.)	---
5	TENEMENTS PROPOSED (10)	---
<b>PARKING STATEMENT</b>		
TOTAL PARKING PROVIDED		
CAR		
SCOOTER		

**CERTIFICATE OF AREA**  
 CERTIFIED THAT THE PLOT UNDER REFERENCE WAS SURVEYED BY ME ON ... & THE DIMENSIONS OF SIDES ETC. OF PLOT STATED ON PLAN ARE AS MEASURED ON THE SITE & THE AREA SO WORKED OUT TALLIES WITH THE AREA STATED IN THE DOCUMENT OF OWNERSHIP P.P. SCHEME RECORDS DEPTT. / CITY SURVEY RECORDS.

FOR TITLE  
 PROPOSED B.R. HARNE EDUCATIONAL CAMPUS FOR  
 JAI SHREE SIDDHIVINAYAK FOUNDATION of GUT NO. 110/1,  
 111/1, 111/3, 111/4, 126/1, 126/2, 141PT, 114/2 OF  
 VILLAGE - KARAV, TAL. AMBERNATH, DIST. THANE

OWNER SIGN: JAI SHREE SIDDHIVINAYAK FOUNDATION  
 ARCHITECTS SIGN: A.S. II  
 CHECKED BY: VINEET  
 SCALE: 1:1000  
 NORTH  
 DRAWN BY: HRESH  
 ACKRUTI ARCHITECTS AND ASSOCIATES  
 A. VINAY PATIL, A. SPHURTI PATIL  
 CS NO. 402/A, EWARD, GALA NO. 203 USHA COMPLEX,  
 CHORBADE GALLI KOLHAPUR - 416001  
 PHONE: 02234401038  
 E-MAIL: 02234401038@gmail.com  
 REG. NO. CA/2010/48815